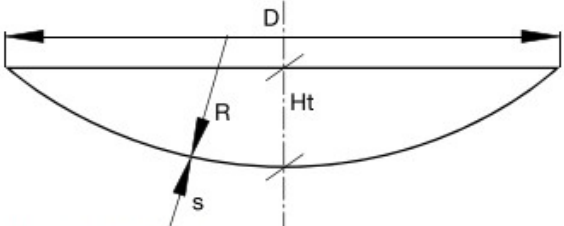
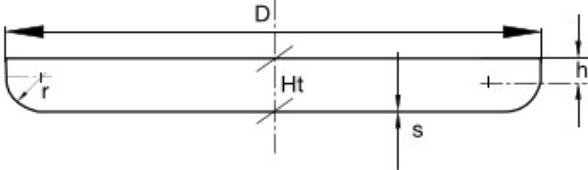
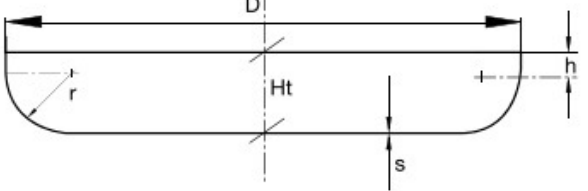
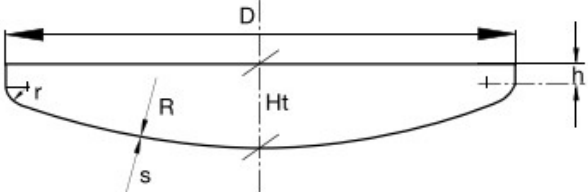
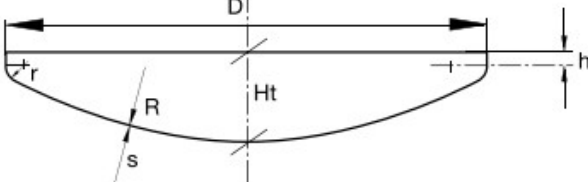

# Dished heads table

Different types of pressed and rolled heads

Type	Drawing	Technical specifications and dimensions																											
<b>A</b>	 <p>Discs, only dished</p>	<table border="1"> <thead> <tr> <th>D</th> <th>R</th> <th>s</th> </tr> </thead> <tbody> <tr> <td>400 + 5000</td> <td>2 x D</td> <td>3 + 60</td> </tr> <tr> <td></td> <td>1,5 x D</td> <td></td> </tr> <tr> <td></td> <td>1 x D</td> <td></td> </tr> <tr> <td></td> <td>0,8 x D</td> <td></td> </tr> </tbody> </table> <table border="1"> <thead> <tr> <th>R = 1,5 x D</th> <th></th> </tr> </thead> <tbody> <tr> <td>SV</td> <td>D x 1,015</td> </tr> <tr> <td>HT</td> <td>D x 0,075 + S</td> </tr> </tbody> </table> <table border="1"> <thead> <tr> <th>R = D</th> <th></th> </tr> </thead> <tbody> <tr> <td>SV</td> <td>D x 1,09</td> </tr> <tr> <td>HT</td> <td>D x 0,140 + S</td> </tr> </tbody> </table>	D	R	s	400 + 5000	2 x D	3 + 60		1,5 x D			1 x D			0,8 x D		R = 1,5 x D		SV	D x 1,015	HT	D x 0,075 + S	R = D		SV	D x 1,09	HT	D x 0,140 + S
D	R	s																											
400 + 5000	2 x D	3 + 60																											
	1,5 x D																												
	1 x D																												
	0,8 x D																												
R = 1,5 x D																													
SV	D x 1,015																												
HT	D x 0,075 + S																												
R = D																													
SV	D x 1,09																												
HT	D x 0,140 + S																												
<b>B</b>	 <p>Flat heads with small knuckle radius (p. 23)</p>	<table border="1"> <thead> <tr> <th>D</th> <th>r</th> <th>h</th> <th>s</th> </tr> </thead> <tbody> <tr> <td>500 + 5000</td> <td>50</td> <td>≥ 5 x S</td> <td>3 + 30</td> </tr> </tbody> </table> <table border="1"> <thead> <tr> <th>SV</th> <th></th> </tr> </thead> <tbody> <tr> <td></td> <td>D + 50 + 2h</td> </tr> <tr> <th>Ht</th> <td>50 + h + s</td> </tr> </tbody> </table>	D	r	h	s	500 + 5000	50	≥ 5 x S	3 + 30	SV			D + 50 + 2h	Ht	50 + h + s													
D	r	h	s																										
500 + 5000	50	≥ 5 x S	3 + 30																										
SV																													
	D + 50 + 2h																												
Ht	50 + h + s																												
<b>C</b>	 <p>Flat heads with big knuckle radius</p>	<table border="1"> <thead> <tr> <th>D</th> <th>r</th> <th>h</th> <th>s</th> </tr> </thead> <tbody> <tr> <td>500 + 5000</td> <td>D/10</td> <td>≥ 5 x S</td> <td>3 + 30</td> </tr> </tbody> </table> <table border="1"> <thead> <tr> <th>SV</th> <th></th> </tr> </thead> <tbody> <tr> <td></td> <td>D x 1,09 + 2h</td> </tr> <tr> <th>Ht</th> <td>D x 0,1 + h + s</td> </tr> </tbody> </table>	D	r	h	s	500 + 5000	D/10	≥ 5 x S	3 + 30	SV			D x 1,09 + 2h	Ht	D x 0,1 + h + s													
D	r	h	s																										
500 + 5000	D/10	≥ 5 x S	3 + 30																										
SV																													
	D x 1,09 + 2h																												
Ht	D x 0,1 + h + s																												
<b>D</b>	 <p>Small knuckle radius dished heads (p. 16-17)</p>	<table border="1"> <thead> <tr> <th>D</th> <th>R</th> <th>r</th> <th>h</th> <th>s</th> </tr> </thead> <tbody> <tr> <td>500 + 3050</td> <td>1,5 + 2 D</td> <td>50</td> <td>≥ 5 x S</td> <td>3 + 32</td> </tr> <tr> <td>3100 + 3450</td> <td>1,5 + 2 D</td> <td>80</td> <td>≥ 5 x S</td> <td>3 + 32</td> </tr> <tr> <td>3500 + 5000</td> <td>1,5 + 2D</td> <td>100</td> <td>≥ 5 x S</td> <td>3 + 32</td> </tr> </tbody> </table> <table border="1"> <thead> <tr> <th>R = 2D r = 50</th> <th></th> </tr> </thead> <tbody> <tr> <td>SV</td> <td>D x 1,03 + 2h</td> </tr> <tr> <td>Ht</td> <td>D x 0,090 + h + s</td> </tr> </tbody> </table>	D	R	r	h	s	500 + 3050	1,5 + 2 D	50	≥ 5 x S	3 + 32	3100 + 3450	1,5 + 2 D	80	≥ 5 x S	3 + 32	3500 + 5000	1,5 + 2D	100	≥ 5 x S	3 + 32	R = 2D r = 50		SV	D x 1,03 + 2h	Ht	D x 0,090 + h + s	
D	R	r	h	s																									
500 + 3050	1,5 + 2 D	50	≥ 5 x S	3 + 32																									
3100 + 3450	1,5 + 2 D	80	≥ 5 x S	3 + 32																									
3500 + 5000	1,5 + 2D	100	≥ 5 x S	3 + 32																									
R = 2D r = 50																													
SV	D x 1,03 + 2h																												
Ht	D x 0,090 + h + s																												
<b>DE</b>	 <p>Medium radius heads (p. 22)</p>	<table border="1"> <thead> <tr> <th>D</th> <th>R</th> <th>r</th> <th>h</th> <th>s</th> </tr> </thead> <tbody> <tr> <td>500 + 5000</td> <td>D</td> <td>50 + 180</td> <td>≥ 5 x S</td> <td>3 + 32</td> </tr> </tbody> </table>	D	R	r	h	s	500 + 5000	D	50 + 180	≥ 5 x S	3 + 32																	
D	R	r	h	s																									
500 + 5000	D	50 + 180	≥ 5 x S	3 + 32																									

• With maximum diameters and thicknesses, feasibility much depends on the material used. So, it is always advisable to contact our customers of

• The formulae are purely theoretical.  
• Minimum thickness values refer to flange-formed dished heads

Tipo

Drawing

Technical specifications and dimensions

E

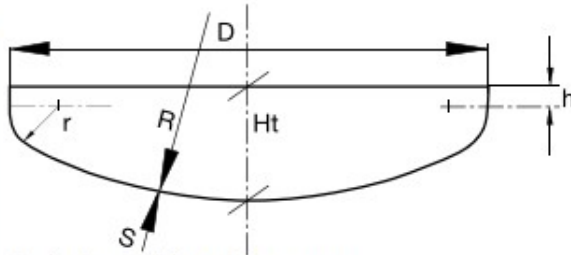

Torispherical heads (p. 18-19)

D	R	r	h	s
320 + 5000	D	D/10	$\geq 5 \times S$	3 + 32

SV	$D \times 1,11 + 2h$
Ht	$D \times 0,194 + h + s$

F

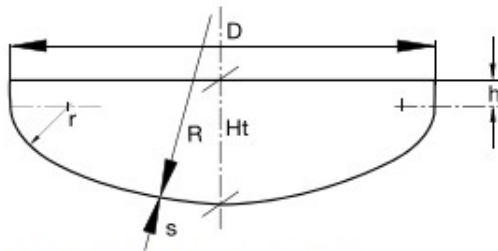

Semielliptical heads (p. 20-21)

D	R	r	h	s
500 + 4000	$0,8 \times D$	D/6,5	$\geq 5 \times S$	3 + 32

SV	$D \times 1,16 + 2h$
Ht	$D \times 0,25 + h + s$

G

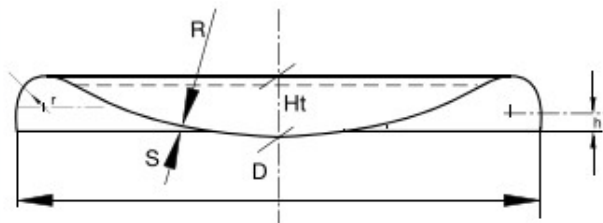

Diffuser heads

D	R	r	h	s
500 + 5000	*	*	$\geq 5 \times S$	3 + 30

\* on request

H

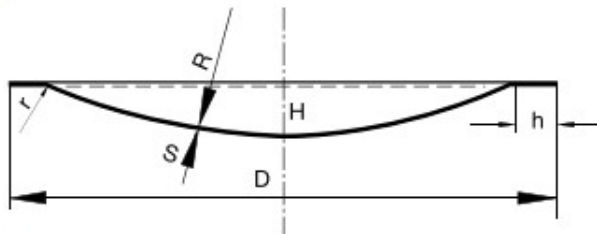
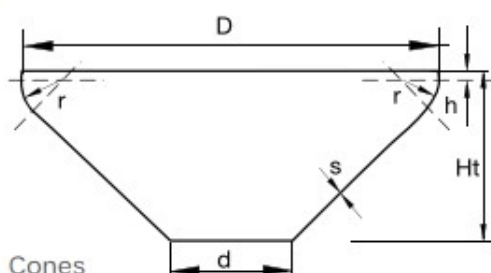

Plate-type heads

D	R	h	s
500 + 5000	*	$\geq 5 \times S$	3 + 30

\* on request

I



Cones

D	r	Ht	h	s	d
500 + 3000	*	max 1150	$\geq 5 \times S$	3 + 32	*

Available also without flanging (open cone)

\* on request